

# HX-1080™ Installation and Repair Solutions

**The Stratos HX-1080 Series Connectors provide robust field deployable, high performance expanded beam solutions for HD & SD Broadcast applications.**

In the event of connector or cable damage due to abuse or misfortune, rapid cost effective and de-skilled field re-instatement is a must to support the successful deployment of any hybrid fibre/electrical broadcast cabling solution.

To complement the Stratos HX1080 connector products unique repair/install solutions are available. Typically three scenarios challenge field deployment.

**(1)** Connector failure, **(2)** Cable failure and **(3)** miscalculations of cable lengths for fixed installations. Stratos provides three strategies to deal with each providing a measured balance between cost, adaptability and performance for each.

**(1)** With factory certified Temporary Repair Patchcords (TRP) (a HX-1080 to LX-1080<sup>(1)</sup> assembly), rapid de-skill repairs using common LC technology are effected in minutes. Half the work is already done, the field work is little more than the use of regular fibre optic pot and polish techniques. Stratos can even offer training courses for those new to the job. TRPs are used either as a permanent repair or temporary re-instatement in which case the TRP can be reused should misfortune strike again.

**(2)** Using similar principles mid-stream cable repair can also be achieved quickly and effectively through the use of a factory terminated LX1080/LX1080 cord. This method even allows short damaged lengths of cable to be removed entirely.

**(3)** The frustrations of permanent installs without storing excessive cable over-lengths are eased by the freedom to easily terminate on site once the cable has been ideally routed. To enable this while exploiting the benefits of the HX-1080 expanded beam interface, Stratos has designed a unique optical feedthrough bulkhead with standard LC pot/polish connections on the rear, a de-skilled on-site terminated LX-1080.

Low skilled, cost effective and rapid solutions available for all eventualities, when the show must go on the Stratos product portfolio makes its as easy as **1 2 3**.

- Low Skill Termination
- Rapid Repair Solution
- Flexible Install Options
- Field Repair Solutions
- Economic
- High Performance
- Easy Clean Interface
- Non-contact Optical
- High Reliability/Durability
- IP 67 Sealing
- Worldwide Support
- Minimum Training

**Top:**

HX-1080 Optical Feedthrough bulkhead allowing all the benefits of a panel mounted expanded beam interface with a low skill field terminable LC Type Optical interconnect to the rear.

**Bottom Left:**

Factory terminated and re-useable HX-1080 to LX-1080 Temporary Repair Patchcord (TRP) assembly can be used to rapidly replace connectors where damage has occurred on cables already deployed.

**Bottom Middle:**

LX-1080 Field termination Component Kit consisting of all the required electrical contacts, LC connectors and consumables.

**Bottom Right:**

Factory terminated and re-useable the LX-1080 patchcord assembly allows damage to cable mid-stream to be repaired whilst minimising termination time in the field.

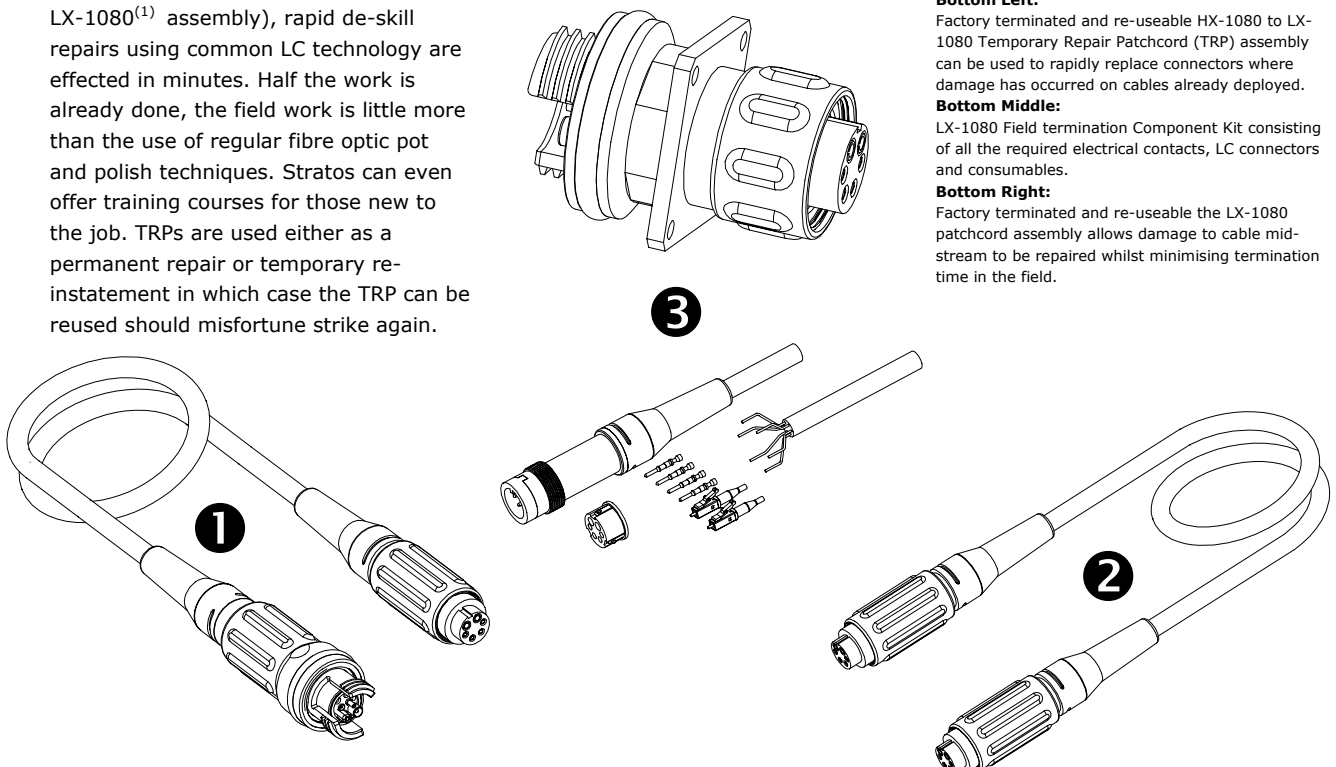

**Stratos Limited (UK)**, Hollands Road Industrial Estate  
Haverhill, Suffolk CB9 8PR, England

**Telephone:** +44 (0)1440 706441 **Fax:** +44 (0)1440 762044

**Website:** <http://www.stratoslightwave.com> **Email:** [ukinfo@stratoslightwave.com](mailto:ukinfo@stratoslightwave.com)