

ISSUE NO.	1	2	3	4	5			
DATE	21/04/06	02-05-06	05-07-06	18-04-07	01-10-09			
C. NOTE NO.	ERA1272	ERA1751	ERA1849	ERA2125	ERA2719			
CHECKED	BH	BH	BH	BH	MS			
APPROVED	CW	GGW	GGW	MEH	GGW			

DRAWN GGW	MATERIAL SEE BOM (SHEET 2)	FINISH CLEAN	UNLESS OTHERWISE STATED: TOLERANCES $\pm$ 0.1 SURFACE FINISH 1.6 $\mu$ m DIMENSIONS IN mm
SCALE: N.T.S.		REMOVE ALL BURRS & SHARP EDGES.	

**EMERSON** © 2009  
 Connectivity Solutions Limited  
 Russell Way, Widford Industrial Estate,  
 Chelmsford, Essex, CM1 3AA, UK.  
 Tel: +44(0)1245 359515 Fax: +44(0)1245 358938

TITLE  
**HX1080 2+2+2 S/M  
 PLUG ASSEMBLY**

SHEET 1 OF 3  
**CONFIDENTIAL DOCUMENT**  
This document and its contents are issued in strict confidence. Neither the whole or any part may be disclosed or copied without written permission.

DRAWING NUMBER  
**CON06376**  
 (DRAWING PREVIOUSLY TL3379)

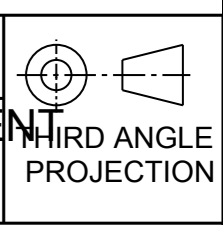

ITEM No	PART NUMBER	DESCRIPTION	No OFF
1	IAS06345	HX1080 2+2+2 HYBRID S/M INSERT	1
2	GRP06385	HX1080 PLUG OVERMOULD GRIP RING ASSY (STRATOS)	1
3	CRI06378	HX1080 2+2+2 PLUG CRIMP TUBE	1
4	HOU06377	HX1080 2+2+2 PLUG OUTER BODY	1
5	HOU06379	HX1080 2+2+2 PLUG REAR BODY	1
6	MPP06364-04	IDENTIFICATION RING - RED	1
7	SEA06380	HX1080 2+2+2 PLUG TAPER SEAL	1
8	BOO06381	HX1080 2+2+2 PLUG BOOT	1
9	SPR03953	S900 INSERT SPRING 05371	1
10	SCR06382	M1.4x0.3 PITCH x 4 LG SOCKET HEAD CAP SCREW ST/ST	2
11	PIN02049	HMA HEADED D1.8 x 3.25 LG ST STEEL CLEAN	1
12	ORI01985	30 ID x 2.0 SEC 'O'RING NITRILE 70 SHORE BLACK	1
13	ORI01959	16.1 ID x 1.6 SEC 'O'RING NITRILE 70 SHORE BLACK	1
14	ORI06375	21.1 ID x 1.6 SEC 'O'RING NITRILE 70 SHORE BLACK	1
15	CRI06383	HX1080 2+2+2 PLUG STRENGTH MEMBER CRIMP	1
16	FAS06343	HX1080 FERRULE ASSEMBLY S/M	2
17	WAS06355	HX1080 CLAMP WASHER	1
18	SCR06356	M2 x 8 SMALL HEAD MACHINE SCREW ST STEEL	1
19	ACC06351	SIGNAL CONTACT MALE	1
20	ACC06352	POWER CONTACT MALE	1
21	ACC06694	SIGNAL CONTACT FEMALE	1
22	ACC06354	POWER CONTACT FEMALE	2
23	ADH06122-NS	POTTING COMPOUND	AS REQD
24	ADH05472-NS	LOCTITE 222	AS REQD
25	CAP06881	HX1080 ONE PART CAP ASSEMBLY	1

ISSUE NO.	1	2	3	4	5			
DATE	05-07-06	02-05-06	05-07-06	18-04-07	01-10-09			
C. NOTE NO.	ERA1272	ERA1751	ERA1849	ERA2125	ERA2719			
CHECKED	BH	BH	BH	BH	MS			
APPROVED	CW	GGW	GGW	GGW	GGW			
DRAWN	GGW		MATERIAL		FINISH		UNLESS OTHERWISE STATED:	
SCALE:	N.T.S.		SEE BOM		CLEAN		TOLERANCES $\pm$ 0.1	
					REMOVE ALL BURRS & SHARP EDGES.		SURFACE FINISH 1.6 $\mu$ m	
							DIMENSIONS IN mm	

**EMERSON** © 2009  
Connectivity Solutions Limited  
Russell Way, Widford Industrial Estate,  
Chelmsford, Essex, CM1 3AA, UK.  
Tel: +44(0)1245 359515 Fax: +44(0)1245 358938

TITLE  
**HX1080 2+2+2 S/M  
PLUG ASSEMBLY**

SHEET 2 OF 3

**CONFIDENTIAL DOCUMENT**

DRAWING NUMBER  
**CON06376**  
(DRAWING PREVIOUSLY TL3379)

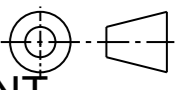

THIRD ANGLE  
PROJECTION

This document and its contents are issued in strict confidence. Neither the whole or any part may be disclosed or copied without written permission.

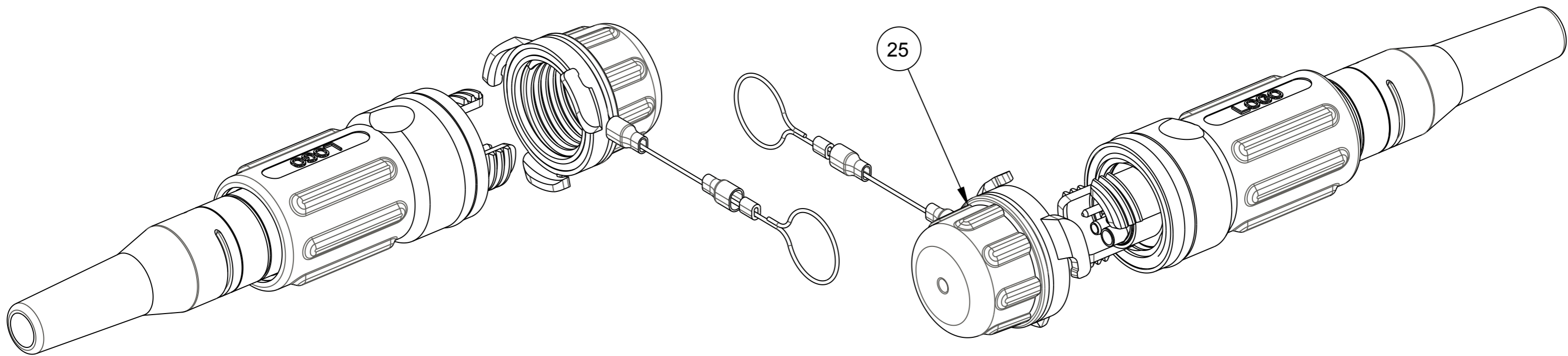
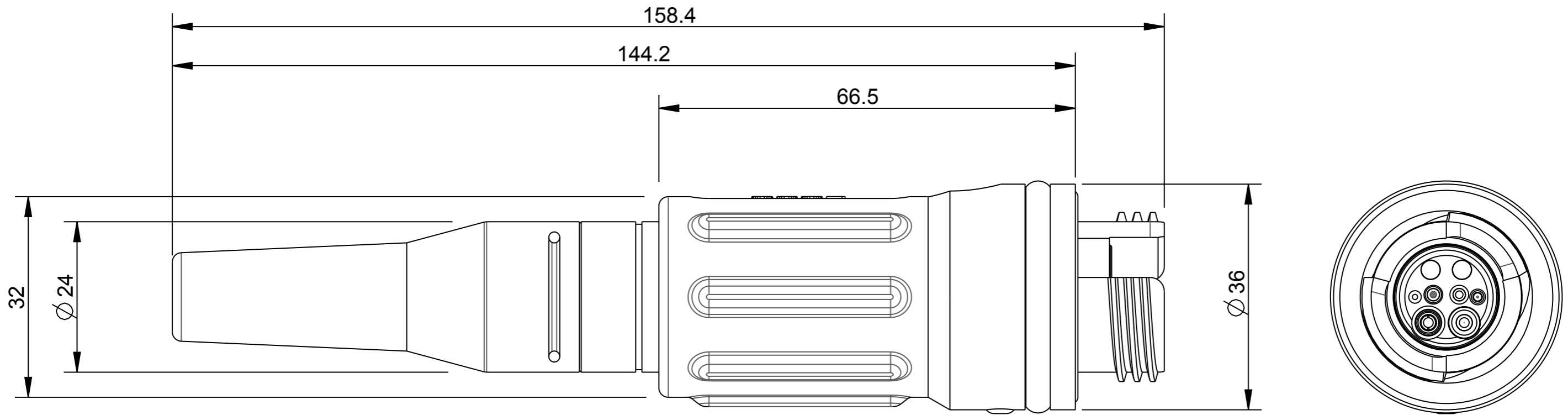

ISSUE NO.	1	2	3	4	5			
DATE	21-04-06	02-05-06	05-07-06	18-04-07	01-10-09			
C. NOTE NO.	ERA1272	ERA1751	ERA1849	ERA2125	ERA2719			
CHECKED	BH	BH	BH	BH	MS			
APPROVED	CW	GGW	GGW	MEH	GGW			
DRAWN	GGW		FINISH		UNLESS OTHERWISE STATED: TOLERANCES $\pm$ 0.1 SURFACE FINISH 1.6 $\mu$ m DIMENSIONS IN mm			
SCALE:	SEE BOM (SHEET 2)		CLEAN		REMOVE ALL BURRS & SHARP EDGES.			
	N.T.S.							

**EMERSON** © 2009  
**Connectivity Solutions Limited**  
 Russell Way, Widford Industrial Estate,  
 Chelmsford, Essex, CM1 3AA, UK.  
 Tel: +44(0)1245 359515 Fax: +44(0)1245 358938

TITLE  
**HX1080 2+2+2 S/M  
 PLUG ASSEMBLY**

SHEET 3 OF 3

**CONFIDENTIAL DOCUMENT**

DRAWING NUMBER  
**CON06376**

